

Accessories which turn the Nederman Friskus fan into a flexible ventilation unit



Welding nozzle with magnet

Fitted to the inlet side of the fan with a Ø100 hose.

Part No.

- 500226 Ø100 mm, in aluminium.
Nozzle inlet 250x25 mm
- 501226 Ø100 mm, in polycarbonate.
Nozzle inlet 250x100 mm

Original hood with magnet

Fitted to the inlet side of the fan with a Ø 160 hose.



Part No.

- 371410 Ø160 mm, in polycarbonate.
Nozzle inlet 300x250 mm

Wheel set

Fitted to the fan stand for ease of transport. Set of 4 wheels.



Part No. 371707

Double adaptor

For connecting two hoses to the fan's inlet side.

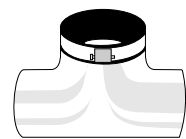

Part No.

- 510726 int. Ø160 mm - 2 x ext. Ø100 mm
- 510826 int. Ø160 mm - 2 x ext. Ø125 mm

Adaptors

Part No.

- 510526 int. Ø160 mm - ext. Ø100 mm
- 510626 int. Ø160 mm - ext. Ø125 mm

Adaptors are required when hose and fan diameters are not the same.

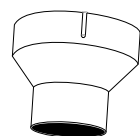

Hoses

Part No.

- 500427 Ø100 mm
- 500527 Ø125 mm
- 511026 Ø160 mm

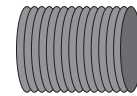

Supplied in 5 metre lengths with 2 hose clips.
Materials: black PVC, PA and steel helix.

Joining tube

Part No.

- 504626 Ø100 mm
- 505626 Ø125 mm
- 371413 Ø160 mm

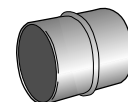

For connecting two or more hoses.

Material specifications, fans

Component	N16/N24
Fan case	Powder coated galvanised sheet steel
Impeller	Die-cast aluminium
Stand	Zinc-plated steel tubing
Inlet manifold	Polypropylene
Safety grille	Polypropylene

Airflow Friskus fans N16, N24

Installation	Fittings	N16 m ³ /h	N24 m ³ /h
Inlet hose	1 x Ø 160 mm with nozzle	1100	1400
	1 x Ø100 mm with nozzle	350	400
	2 x Ø100 mm with nozzle	2x300-600	2x375-750
Outlet hose	1 x Ø160 mm	1000	1300
Inlet and outlet hoses (1 x Ø160 mm)	Inlet side: 1 x Ø160 mm with nozzle	850	1100
	Inlet side: 1 x Ø100 mm with nozzle	350	400
	Inlet side: 2 x Ø100 mm with nozzle	2x275-550	2x350-700

The above apply to 5 m hose lengths.



FRISKUS FAN

POWERFUL PORTABLE VENTILATION UNIT

Bring fresh air into the workplace

Simple, powerful and versatile

The Nederman Friskus fan is a simple and powerful ventilation unit for service, repair and other temporary work. Ideal as an extractor for welding fumes, steam, dust, etc. or for supplying fresh air during work in confined and enclosed spaces.

A compact and easy-to-use fan which, in combination with inlet and outlet hoses, makes a flexible and versatile unit with a wide range of applications.



Tried, tested and complete

The Friskus fan is available in two versions using Nederman's well-known N16 and N24 fans, mounted on a sturdy stand with practical, well balanced carrying handles.

Both inlet and outlet are fitted with hose spigots and safety grills. This means that the fan can be used with a hose connected to the inlet or the outlet, or for maximum reach, with hoses on both.

Supplied with integral motor cut-out, circuit-breaker and plug-connector for an extension lead. It can also be fitted with wheels for ease of transport as well as hoses, double adaptor and various types of extractor hood.

WARNING
The fans must not be used where there is a risk of explosion or for the transport of inflammable or explosive gases.



Friskus fan for service work

The Friskus fan is convenient and easy to carry in a service vehicle. The fan can be used for extraction, air supply and air circulation.



Friskus fan for fresh-air supply

In enclosed or confined spaces, the Friskus fan can considerably improve the work environment by blowing in fresh air.

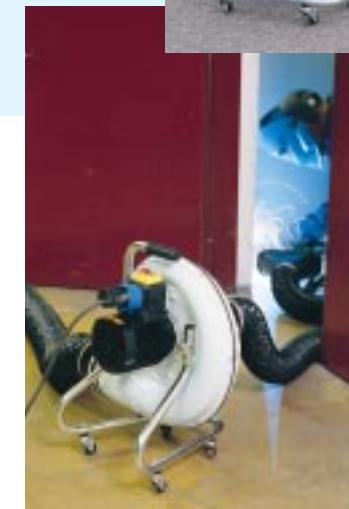

Friskus fan for temporary localised extraction

Localised extraction involves the capture at source of hazardous fumes and dust, before they reach the worker's breathing zone. During service and other temporary work, the Friskus fan is a simple and ideal solution to ventilation problems.

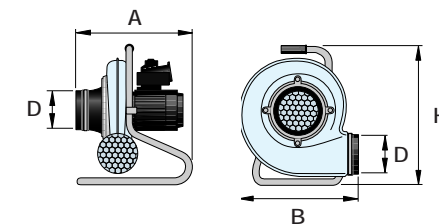

Dimensions

Fan	Dimensions in mm			
	A	B	D	H
N16	430	484	Ø160	550
N24	430	484	Ø160	550

Model	Series	Motor power kW	Frequency Hz	Speed rpm	Voltage V	Phase	Current A	Weight kg	Noise level acc. ISO 11203 dB(A)	Part. No.
N16	521	0.47	50	2800	220-230	1	3.9	17	74-76	511321
N16	521	0.47	50	2800	110	1	8	17	74-76	511921
N24	522	0.75	50	2800	220-230	1	5.5	21	75-79	511322
N24	522	0.75	50	2800	110	1	11	21	75-79	511922